

Emergency Lowering Instructions

Genie Electric Scissor Lifts

Machine Range: GS1930, GS1932, GS2032, GS2046,
GS2632, GS2646, GS3232 and GS3246



If there is a machine breakdown or if the operator becomes incapacitated it may be necessary to perform an emergency rescue from the ground. Emergency rescues must be rehearsed routinely.



Warning

While every effort is made to ensure that the information provided is accurate and up to date, we are not able to guarantee the completeness and accuracy of these instructions and you should therefore not rely on them. Nationwide Platforms Ltd accepts no liability for reliance on the contents of this information sheet which has been produced as additional GUIDANCE ONLY and is not intended to replace the manufacturer's manual. You should refer to the manufacturer's manual.

You should not operate this Mobile Elevating Work Platform (MEWP) unless you are suitably trained and fully familiarised with its operation and the emergency procedures set out in the manufacturer's manual. Operating plant necessarily involves risk of injury to the person.

A

Before starting work consider the following:

- Will there be a second person in the vicinity of the machine to undertake a rescue if required?
- Have both the operator and rescuer been familiarised with ground controls?
- Can the rescuer gain access to the ground controls? i.e. Ensure that the machine is not parked with the ground controls facing a wall or similar obstruction.
- Is the key in the ground control to allow the rescuer to switch power from basket to ground controls?

B

Before attempting to lower platform:

- It is imperative that an inspection be carried out to ensure the lowering of the boom is not hindered by obstructions such as steel work, pipes, cables, etc.
- If the operator in the cage has been incapacitated ensure they will not be put in additional danger by operation of the platform. Remember that completing a rescue in 4-6 minutes may be critical.
- If unsure seek help (it may be necessary to carry out a mid air rescue).
- Carefully plan each action before starting to lower the platform.

C

If the engine can be started from the ground control:

- 1 Check for any obstructions.
- 2 Turn the Key Switch to "Ground" position.
- 3 Pull the Emergency Stop Switch out.
- 4 Start the engine by using the Start Switch.
- 5 Position the Engine Speed Switch to the hare symbol.
- 6 Push and hold in the Function Enable Switch.
- 7 Operate and hold the required Function Switch to lower the boom sections.

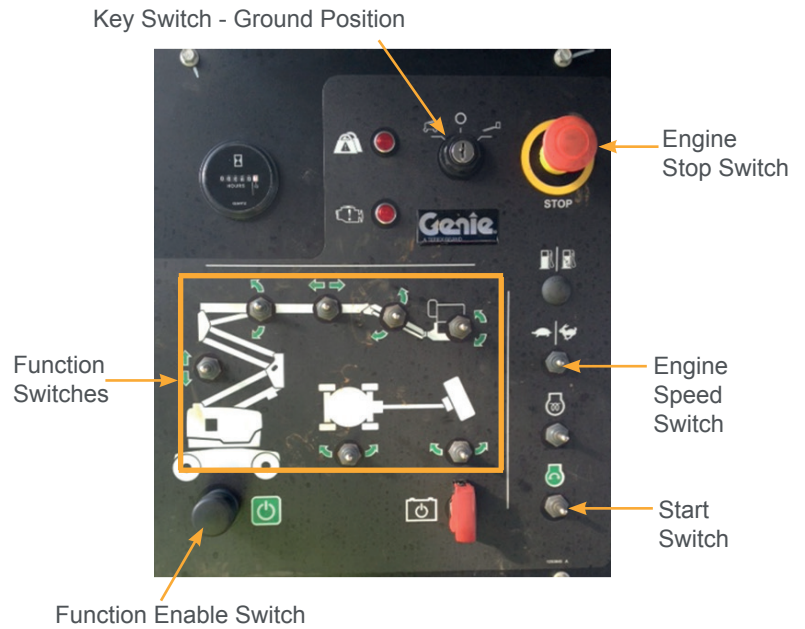

Panels may vary slightly in appearance depending on year and model but all have the same functions

D

If the engine cannot be started from the ground:

In the case where the boom cannot be directly lowered or if the operator is trapped, it is necessary to use the **Auxiliary Power Function** until the boom is clear. This will give the rescuer more precise control of each function. Once all obstructions have been cleared normal operation of the boom using the engine should be resumed.

- 1 Turn the Key Switch to the "Ground" position.
- 2 Pull Emergency Stop Switch out.
- 3 Lift up the red cover and operate the exposed auxiliary switch while simultaneously operating and holding the required Function Switch until the boom sections are lowered.

N.B In the event of the cage overload being activated, the engine will not continue to run, use the Auxiliary function to lower the boom as described in section D of this plan.

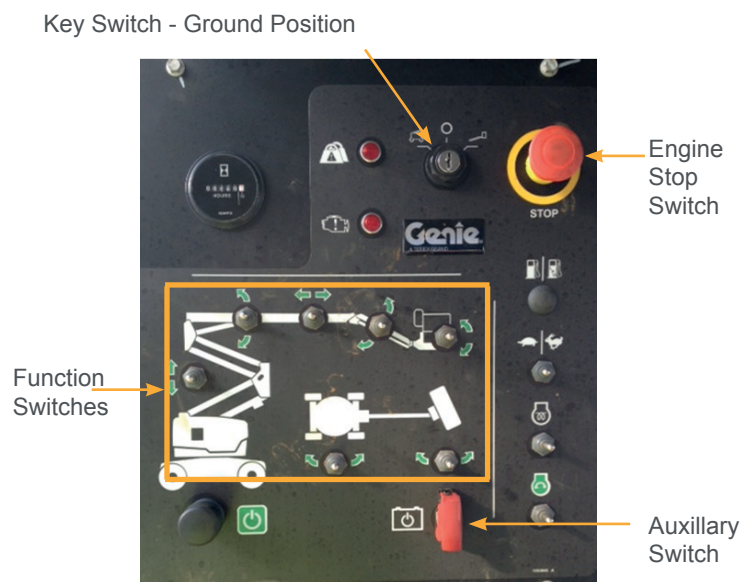

E

If the operator is able to start the engine from the platform and it is clear to lower the boom sections down:

- 1 Pull the Emergency Stop Switch out on the platform control panel.
- 2 Start the engine by using the Start Switch.
- 3 Operate and hold down the Foot Switch.
- 4 Operate required Function controls to lower the boom sections.

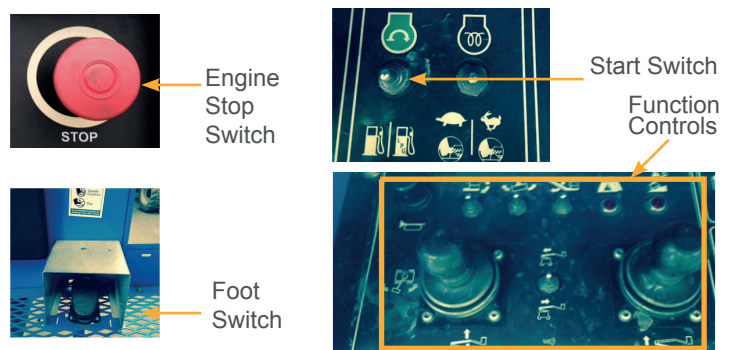

F

If the engine cannot be started from the platform:

- 1 Pull Emergency Stop Switch out.
- 2 Press and hold down the Foot Switch.
- 3 Lift up the red cover and operate the exposed Auxiliary Switch while simultaneously operating and holding the required Function Switch until the boom sections are lowered.



Engine Stop Switch



Foot Switch

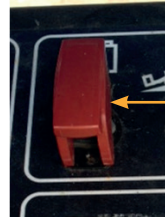

Auxiliary Switch



Function Controls

G

Technical advice and training courses

If the controls do not function or you are unsure of their operation please call our Technical Support team on 0845 745 0000 option 2.

As the UK's largest training provider in our industry, we have a range of courses to help you and your operators to work efficiently and safely at height.

Contact us for full details of courses and dates.