

# Emergency Lowering Instructions

## SkyJack Electric Scissor Lifts

Machine Range: 3215, 3219 and 3220



If there is a machine breakdown or if the operator becomes incapacitated it may be necessary to perform an emergency rescue from the ground. Emergency rescues must be rehearsed routinely.



### Warning

While every effort is made to ensure that the information provided is accurate and up to date, we are not able to guarantee the completeness and accuracy of these instructions and you should therefore not rely on them. Nationwide Platforms Ltd accepts no liability for reliance on the contents of this information sheet which has been produced as additional GUIDANCE ONLY and is not intended to replace the manufacturer's manual. You should refer to the manufacturer's manual.

You should not operate this Mobile Elevating Work Platform (MEWP) unless you are suitably trained and fully familiarised with its operation and the emergency procedures set out in the manufacturer's manual. Operating plant necessarily involves risk of injury to the person.

### A

### Before starting work consider the following:

- Will there be a second person in the vicinity of the machine to undertake a rescue if required?
- Have both the operator and rescuer been familiarised with the ground controls?
- Can the rescuer gain access to the ground controls? i.e. Ensure that the machine is not parked with the ground controls facing a wall or similar obstruction.
- Is the key in the ground control to allow the rescuer to switch power from basket to ground controls? (Note: on some Skyjack models the key switch is on the platform necessitating emergency lowering using the emergency lowering valves.)

### B

### Before attempting to lower platform:

- It is imperative that an inspection be carried out to ensure the lowering of the platform is not hindered by obstructions such as steel work, pipes, cables, etc. It may be necessary to retract the extension deck prior to lowering.
- If the operator has been incapacitated ensure they will not be put in additional danger by lowering of the platform. Remember that completing a rescue in 4-6 minutes may be critical.
- If unsure seek help (it may be necessary to carry out a mid air rescue).
- Carefully plan each action before starting to lower the platform.

# C

## Lowering the platform using base controls:

In order of preference, always attempt C before attempting D

**Warning: do not hold onto or place any part of the body through the scissor arms due to crushing risk.**

- 1 Check for any obstructions.
- 2 Turn Key Switch fully clockwise to “base” position and hold.
- 3 Pull out or twist Emergency Stop.
- 4 Operate and hold Function Switch in downwards position.
- 5 Lower the platform until it is 7 ft (2.1m) from the ground and then stop.
- 6 Release Function Switch and check for obstructions in scissor pack and that no one is standing under the extension deck if extended.
- 7 Turn Key Switch fully clockwise to “base” position and hold.
- 8 Operate and hold Function Switch in downwards position until platform fully lowered.

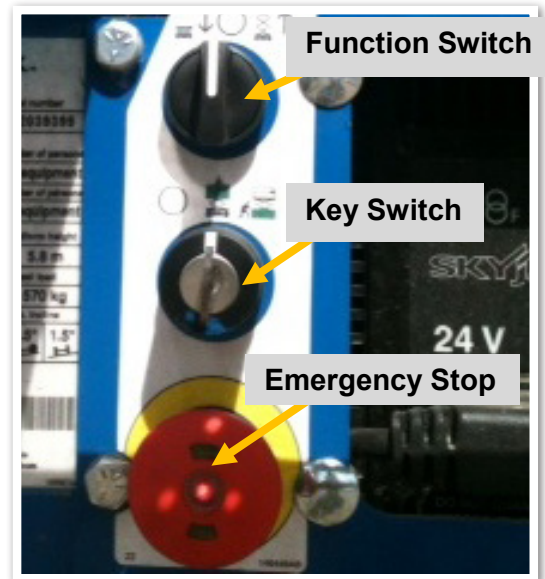

# D

## Lowering the platform using emergency lowering handle:

**Warning: do not hold onto or place any part of the body through the scissor arms due to crushing risk.**

- 1 Check for any obstructions.
- 2 Locate the Holding Valve Override Knob at the base of the lift cylinder. Depress and turn knob counter clockwise. The knob should stop and then click out slightly.
- 3 Pull and hold the Emergency Lowering Valve located at the left hand side of the machine base (you should hear a hissing sound as the oil flows back through the system).
- 4 Lower the platform until it is approximately 7 ft (2.1m) from the ground and release lowering valve to stop the descent.
- 5 Check for obstructions in scissor pack and that no one is standing under the extension deck if extended.
- 6 Pull and hold Emergency Lowering Valve to lower platform fully (note: the scissor will not lift following the emergency lowering procedure until the override knob has been reset).



# E

## Technical advice and training courses

If the controls do not function or you are unsure of their operation please call our Technical Support team on 0845 745 0000 option 3.

As the UK's largest training provider in our industry, we have a range of courses to help you and your operators to work efficiently and safely at height.

Contact us for full details of courses and dates.